

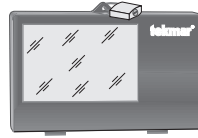

Enclosure A

Enclosure A is a robust housing for the control and associated wiring. Safety dividers in the wiring chamber are provided to separate low and high voltage wiring.



Locking Cover 006

Locking Cover 006 is designed to fit Enclosure A. This cover has a plastic window and is supplied with a lock and key. The cover allows the installer to prevent unwanted tampering with the settings on the control.



Enclosure C

Enclosure C is designed for smaller controls and their wiring. This enclosure has either a large or a small window opening depending on the control used.

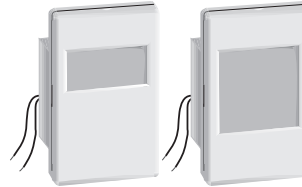

Enclosure D

Enclosure D is the same as enclosure C except that it has a large chamber on its back which is normally used to house an additional relay for pumps or other large electrical loads.

Enclosure A – Assembly and Instructions

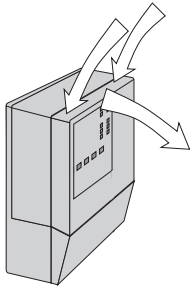

Press down at the fingertip grips on top of the front cover and pull out and down.

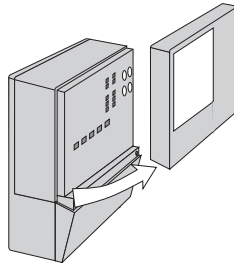

Lift the front cover up and away from the control.

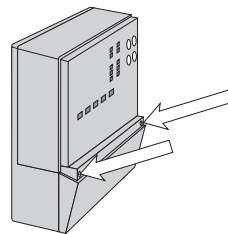

Loosen the screws at the front of the wiring cover.

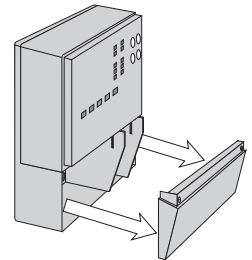

The wiring cover pulls straight out from the wiring chamber.

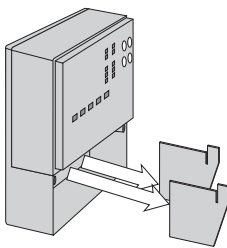

Remove the safety dividers from the wiring chamber by pulling them straight out of their grooves.

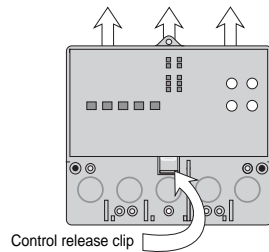

Press the control release clip on the base inside the wiring chamber and slide the control upwards.

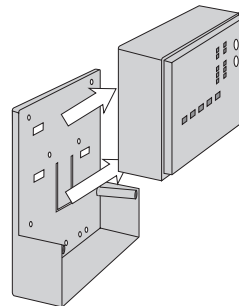

The control lifts up and away from the base.

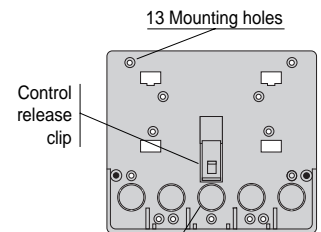

There are 10 conduit knock-outs at the back and bottom of the wiring chamber.

The base is ready for mounting.

The control can be mounted on a standard DIN rail. First remove the control from its base and then, using the hooks and spring clip on the back of the control, mount it onto the DIN rail. This will be a popular option for those who prefer to mount the control inside a larger electrical panel.

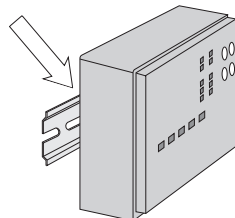

The wiring can enter the bottom or the back of the enclosure. Knock-outs provided in the base allow the wiring to be run in conduit up to the enclosure. The base also has holes that line up with the mounting holes of most common electrical boxes.

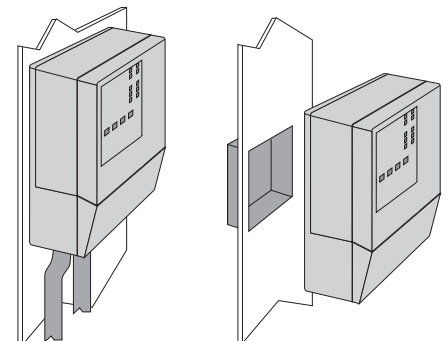

Enclosures C and D —Assembly and Installation

Mounting the C Enclosure

Grasp the front cover by the fingertip grips on the top and bottom of the enclosure and pull the front cover off. Remove the wiring cover screw. The enclosure is either mounted flush onto a wall or it can be placed onto a 2" x 4" electrical box. The mounting holes in the enclosure accept #6 screws. Wiring to the control enters the wiring chamber through the back or bottom of the enclosure. To reassemble the enclosure, first replace the wiring chamber cover and then push the front cover onto the enclosure until it snaps into place.

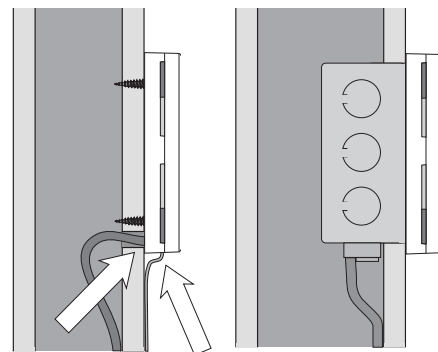
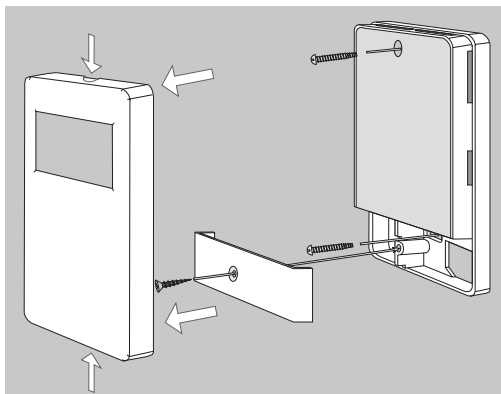

Mounting the D Enclosure

Enclosure D can be mounted on a 2" x 4" duplex electrical box with a minimum depth of 1.75". The front cover is removed by following a similar procedure given for Enclosure C. Rough-in wiring is made to the electrical box using standard wiring practices. High voltage wiring connections are made inside the electrical box directly to the wires exiting the back of the control. Low voltage and sensor wiring enters the wiring chamber through the back or bottom of the enclosure depending on local electrical code requirements.

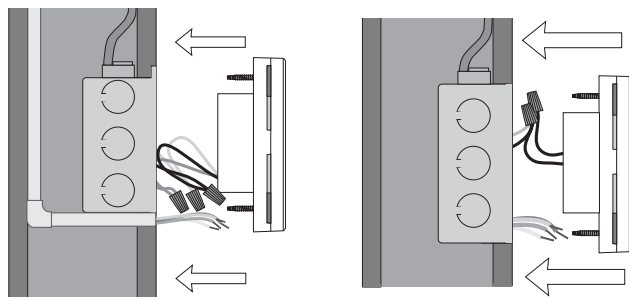

Technical Data

	Enclosure A	Enclosure C	Enclosure D
Color	— Blue	Off-white	Off-white
Type	— NEMA 1	NEMA 1	NEMA 1
Material	— PVC or PPO plastic	PVC or ABS plastic	PVC or ABS plastic
Dimensions (inches)	— 6-5/8 x 7-9/16 x 2-13/16	4-3/4 x 2-7/8 x 7/8	4-3/4 x 2-7/8 x 1-7/8
H x W x D (mm)	— 170 x 193 x 72	120 x 74 x 23	120 x 74 x 49

Limited Warranty and Product Return Procedure

Limited Warranty *The liability of tekmar Control Systems Ltd. and tekmar Control Systems, Inc. ("tekmar") under this warranty is limited. Please read and understand the conditions appearing herein.*

tekmar warrants each tekmar product against defects in workmanship and materials, when the product is installed and used in compliance with tekmar's instructions. The warranty period is for a period of twenty-four (24) months from the production date if the product is not installed during that period, or twelve (12) months from the documented date of installation if installed within twenty-four (24) months from the production date, but in any event the warranty period shall not extend beyond thirty-six (36) months from the production date. During the warranty period, tekmar will, at its discretion, either repair at no charge, exchange or give credit for the defective product, provided the product is returned to tekmar.

The liability of tekmar shall be limited to the cost of parts and labour provided by tekmar to correct defects in materials and / or work-manship or to the exchange of the defective product for a replacement product or to the granting of credit limited to the original cost of the product, at tekmar's discretion, and such repair, exchange or credit shall be deemed to be the sole remedy available from tekmar. This warranty does not cover the cost of the parts or labour to remove or to transport the defective product, or to reinstall the repaired or replacement product. Returned products that are not defective are not covered by this warranty.

This warranty does not apply if the product has been damaged by accident, abuse, misuse, negligence, fire, Act of God, or has been damaged by modifications, alterations or attachments made subsequent to purchase which have not been authorized by tekmar, or if the product was not installed in compliance with the local codes and ordinances, or if due to defective installation of the product.

The warranty applicable to a product is as set out in the statement of warranty policy (the "Warranty") above, receipt of which is hereby acknowledged. The liability of tekmar is limited to those obligations identified in the warranty as obligations of tekmar. The warranty is understood to be in substitution for any loss, costs or damages for which tekmar might otherwise be liable at law or in equity and in particular, in lieu of any liability for fundamental breach of contract.

tekmar disclaims any responsibility for losses, expenses, inconveniences, or any special, indirect, secondary, incidental or consequential damages arising from ownership or use of any items subject to any claim hereunder, regardless of whether such claim is stated in contract, tort or strict product liability.

This warranty is in lieu of all other warranties, express or implied, including, without limitation, warranties of merchantability, fitness for a particular purpose, durability or description of the product, its non-infringement of any relevant patents or trademarks, and its compliance with or non-violation of any applicable environmental, health or safety legislation. No implied warranties shall extend beyond twenty-four (24) months from the production date.

Some states or provinces do not allow limitations on how long an implied warranty lasts, so the above limitation may not apply to you. This warranty gives you specific legal rights, and you may also have other rights which vary from state to state or province to province.

Product Return Procedures Products that are believed to have defects in workmanship or materials must be returned, together with a written description of the defect, to the tekmar representative for that territory. If the address of the representative is not known, please request it from tekmar at the telephone number listed below.

In North America: tekmar Control Systems Ltd., Canada
tekmar Control Systems, Inc., U.S.A.
Head Office: 4611 - 23rd Street
Vernon, B.C. Canada V1T 4K7
Tel. (604) 545-7749 Fax. (604) 545-0650